

Lot Fill Area Greater Than 1.50m Depth

NOTE: Engineered Fill Testing was conducted in areas where fill was greater than 1.50m. Refer to geotechnical letter for building foundation recommendations.

GRADING TYPE	STANDARD SPLIT DRAINAGE
HOUSE TYPE	_____
FINISHED FLOOR	_____
BOTTOM OF FOOTING	_____
TOP OF BASEMENT WALL	_____
GARAGE FLOOR	_____
LOT	12
BLOCK	3
PLAN	132 4537
ADDRESS	2512 YOHU INLET

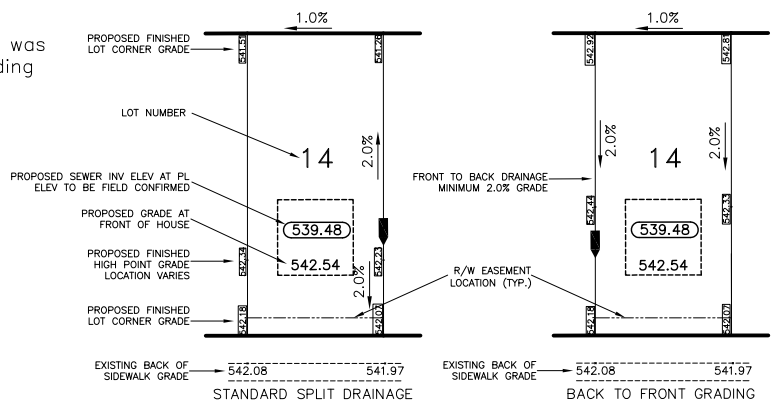

NOTES:

- INITIAL MINIMUM GRADE OF 10% OVER A DISTANCE OF 1.5m TO BE PROVIDED AROUND ALL BUILDINGS.
- MINIMUM STANDARD LOT GRADE IS 2.0%
- ROUGH GRADE LOT ELEVATIONS ARE 300mm BELOW FINAL GRADES. FINAL GRADES TO BE SET +/- 100mm

NOTE:

THIS GRADE SLIP IS PREPARED BY THE DEVELOPER. THE CITY OF COLD LAKE IS NOT RESPONSIBLE FOR THE INFORMATION PROVIDED.

SCALE 1:500	PROJECT No. 41-09-05		TCG DEVELOPMENTS INC.
DESIGNED BY SBE	DRAWN BY MK		NW 23-63-2-4
CHECKED BY	DATE NOVEMBER 12, 2013		PARKVIEW EAST SUBDIVISION PHASE II BUILDING GRADE CERTIFICATE